

CITY OF PITTSFIELD, ILLINOIS

AVAILABLE COMMERCIAL DEVELOPMENT SITES WITHIN PITTSFIELD TIF DISTRICT I

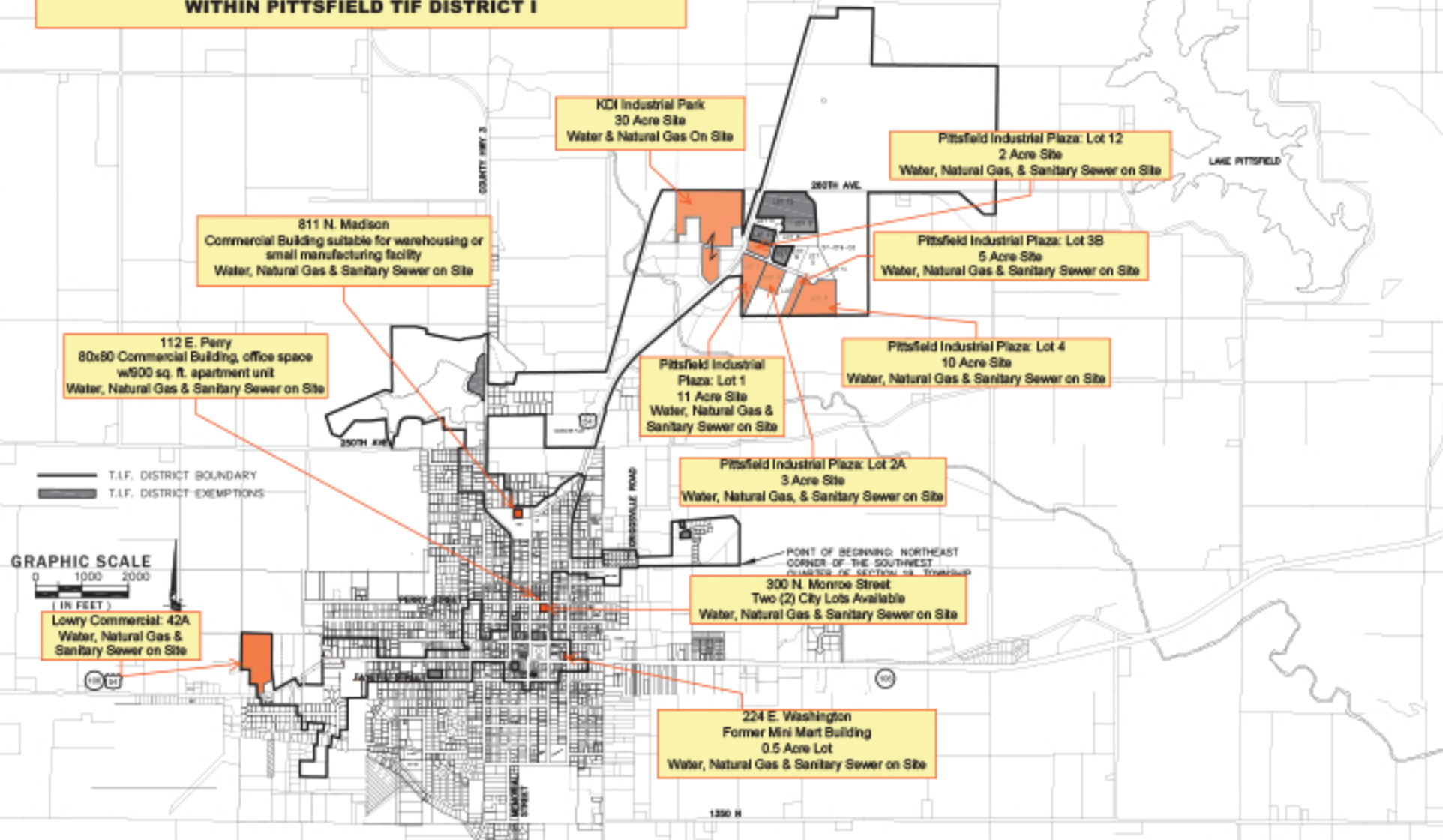

IF THIS DRAWING IS EMPLOYED FOR ANY PURPOSE OTHER THAN THAT FOR WHICH IT WAS PREPARED, THE USER ASSUMES ALL LIABILITY FOR ANY INADEQUACIES OR INACCURACIES.

NO.	DATE	REVISION DESCRIPTION

AMECO ENGINEERING COMPANY, INC.
ENGINEERS + SURVEYORS

100 SOUTH MADISON
PITTSFIELD, IL 62450
PHONE (217) 350-2800
FAX (217) 350-2800

CITY OF PITTSFIELD
215 NORTH MONROE
PIKE COUNTY, ILLINOIS

DESIGNED BY	DRAWN BY	CHECKED BY	APPROVED BY	DATE

PROJECT NUMBER	SHEET NO.